

NOTES

- CONTRACTOR TO VERIFY LOCATION OF EXISTING SERVICES PRIOR TO COMMENCING WORKS. CONTRACTOR IS RESPONSIBLE FOR ANY DAMAGE CAUSED TO EXISTING SERVICES AND RAMIFICATIONS OF SUCH DAMAGE.
- ALL WORK TO BE IN ACCORDANCE WITH THE CURRENT VERSION OF B.V.S.C. DEVELOPMENT DESIGN & CONSTRUCTION SPECIFICATIONS & THE N.C.C. UNLESS NOTED OTHERWISE BY B.V.S.C.

BRIDGE DESIGN NOTES

- WE RECOMMEND 7 x EQUAL 16.5m BRIDGE SPANS DUE TO:
 - PROPOSED PIER LOCATIONS ARE CLEAR OF EXISTING PIERS SO SHOULD NOT INTERFERE WITH ANY RESIDUAL PIERS.
 - SHORTER SPANS WILL KEEP BRIDGE DECK THICKNESS REDUCED RATHER THAN USING THE LARGER SPAN AND INCREASED DEPTH OFFERED BY THE SUPER-T RMS STD GIRDERS.
 - AN INCREASED NUMBER OF PIERS (6 PIERS PROPOSED) COULD DISTRIBUTE LESS IMPACT LOADS FROM OCEAN WAVES TO EACH PIER IF THE BRIDGE DECK IS IMPACTED BY WAVE ACTION.
- WE RECOMMEND A COASTAL INUNDATION HAZARD STUDY BE PERFORMED TO ASSESS THE SIGNIFICANCE OF BEACH EROSION, WAVE ACTION AND INUNDATION DURING SIGNIFICANT STORM EVENTS, PRIOR TO ANY FURTHER DESIGN. TO RAISE LEVEL OF BRIDGE TO BE CLEARER OF WAVE ACTION MAY PROTECT BRIDGE BUT WOULD INVOLVE SIGNIFICANT APPROACH WORKS. THIS HOWEVER MAY BE RECOMMENDED BY THE COASTAL INUNDATION HAZARD STUDY. IT SHOULD BE NOTED THAT THE SOUTHERN APPROACH TRAVERSES BEHIND THE LENGTH OF CUTTAGEE BEACH AT A LEVEL SIMILAR TO THE EXISTING BRIDGE LEVEL. THIS ROAD WAS ERODED FROM WAVE ACTION DURING THE SEVERE COASTAL STORMS WHICH OCCURRED IN THE EARLY 1970'S.

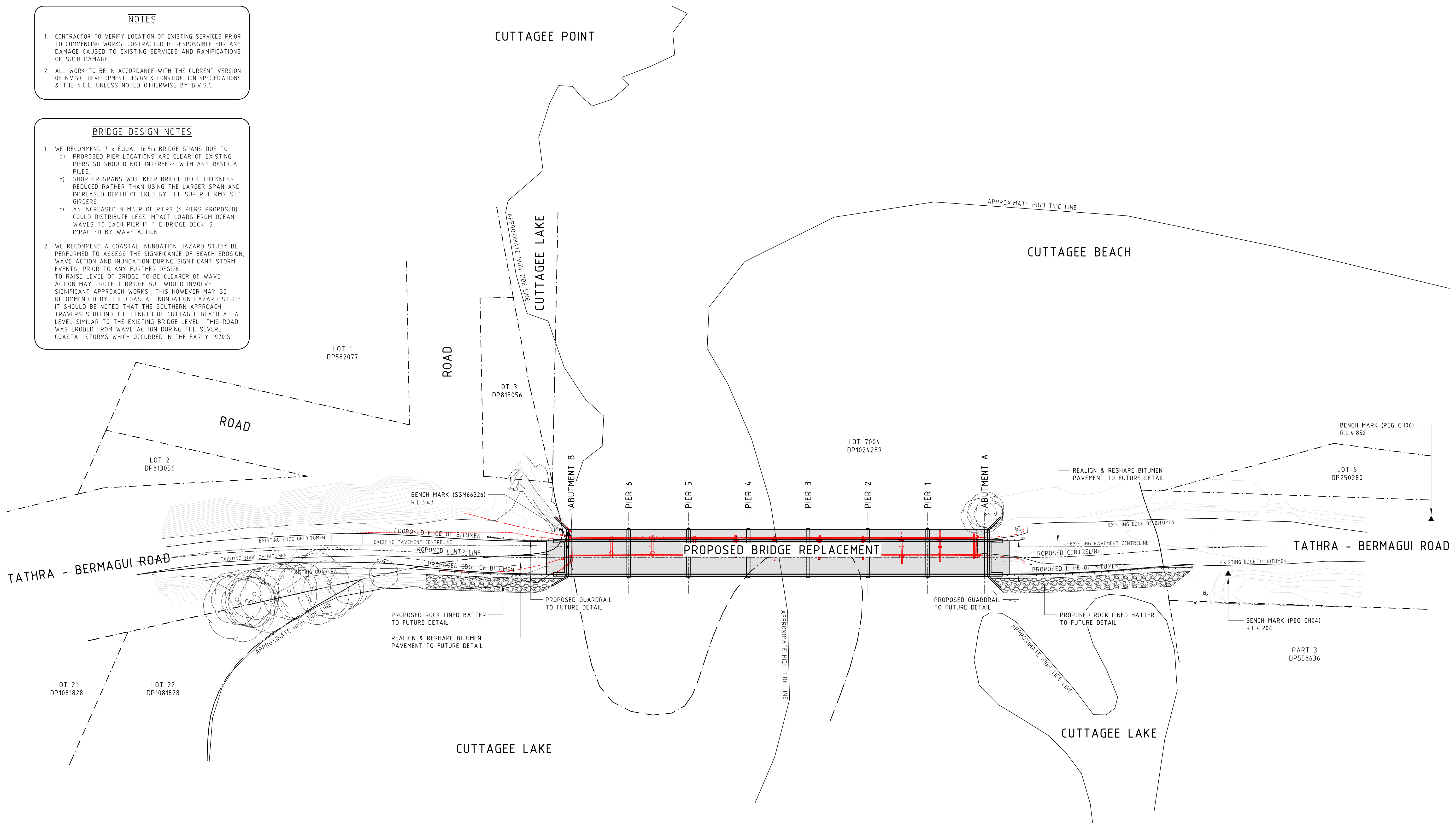

SITE PLAN

PRELIMINARY
NOT FOR CONSTRUCTION

Rev.	Description	Eng.	Date	Rev.	Description	Eng.	Date
P1	PRELIMINARY DESIGN ISSUE	A.M.	07.08.20				
P2	PRELIMINARY DESIGN ISSUE	A.M.	12.08.20				

MARSHMAN O'NEILL ENGINEERS CONSULTING STRUCTURAL CIVIL

ANDREW MARSHMAN & ASSOCIATES PTY LTD ABN 86 064 689 696
 35a Main Street (P.O. Box 768) Merimbula NSW 258
 PH: 02 64 95 1670 FAX: 02 64 95 3456
 andrewmarshmanengineers.com.au

PROJECT
CUTTAGEE LAKE BRIDGE REPLACEMENT
TATHRA - BERMAGUI ROAD, CUTTAGEE, NSW for BEGA VALLEY SHIRE COUNCIL

Copyright © Andrew Marshman & Associates Pty Limited (2009). All rights reserved. This document and all works comprised in it are copyright and no part of it may in any form or by any means (including without limitation, electronic, mechanical, microcopying, photocopying, recording, scanning or otherwise) be reproduced, modified, sorted in a retrieval system, published, distributed or any part of these works is granted to any person without the express prior written consent of Andrew Marshman & Associates Pty Limited and any implied licence to use any part of these works is expressly excluded.

TITLE		SITE PLAN			
Design A. MARSHMAN	Drawn D. ELCOAT	Approved ANDREW MARSHMAN BE (HONSII) MIE Aust (1389076) CPEng NER Chartered Engineer		Job. No. AC20022.06	Sheet C2.1
Scale 1500 (A1) 1:1000 (A3)	Date AUGUST 2020	Rev. P2			

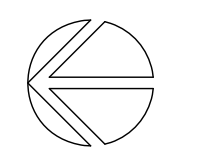

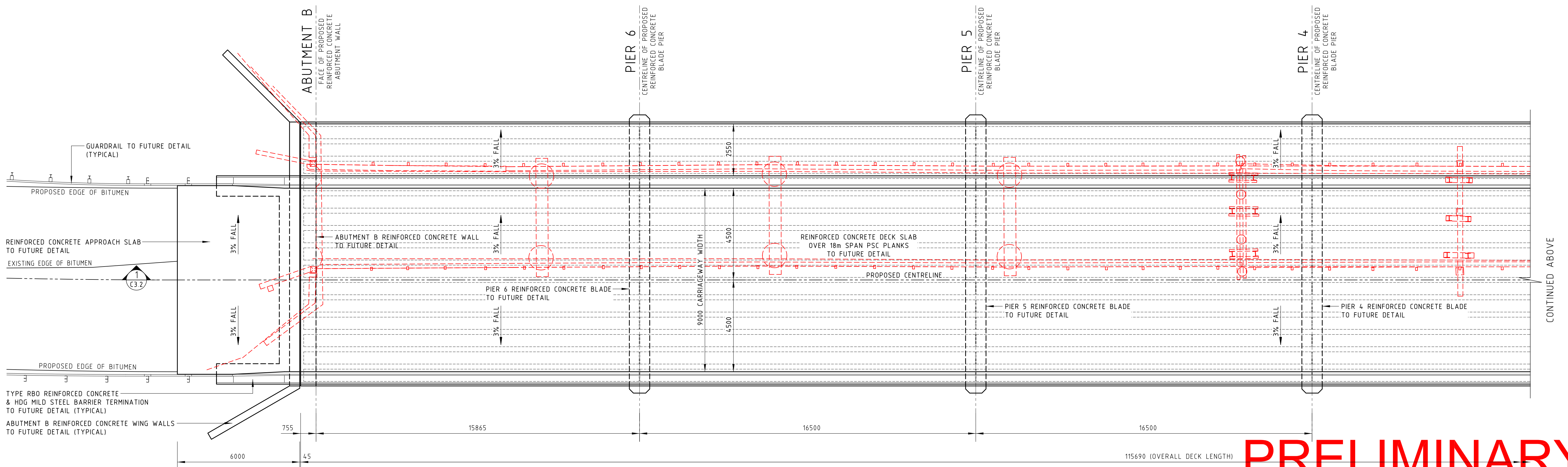
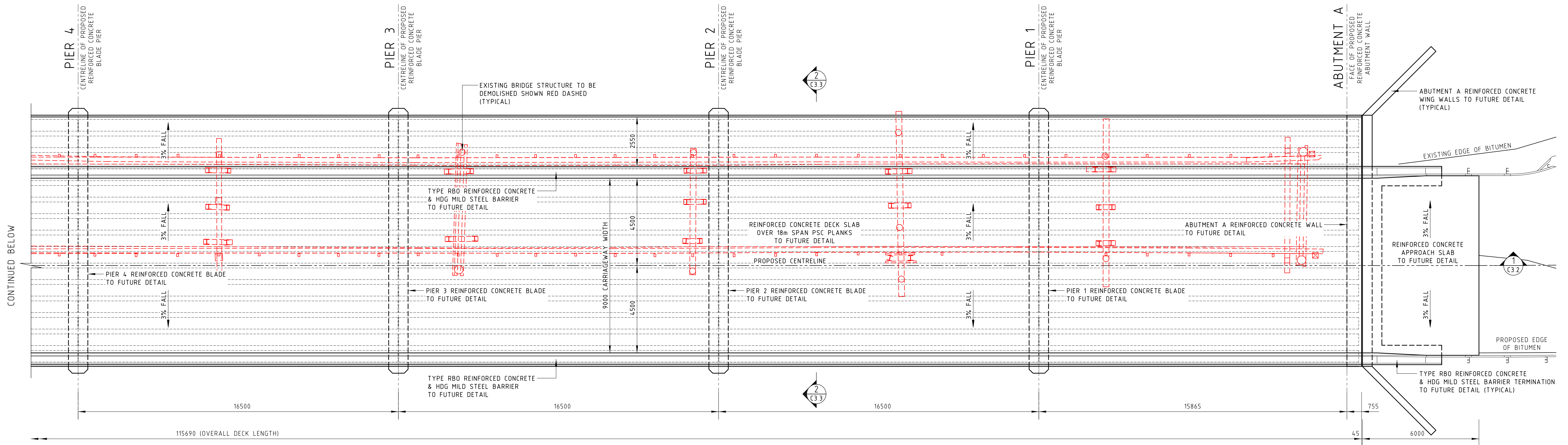

GENERAL ARRANGEMENT PLAN

PRELIMINARY
NOT FOR CONSTRUCTION

Rev.	Description	Eng.	Date	Rev.	Description	Eng.	Date
P1	PRELIMINARY DESIGN ISSUE	A.M.	07.08.20				
P2	PRELIMINARY DESIGN ISSUE	A.M.	12.08.20				

MARSHMAN O'NEILL ENGINEERS CONSULTING STRUCTURAL CIVIL

ANDREW MARSHMAN & ASSOCIATES PTY LTD ABN 86 064 689 696
 35a Main Street (P.O. Box 768) Merimbula NSW 258
 PH: 02 6495 1670 FAX: 02 6495 3456
 andrewmarshmanengineers.com.au

PROJECT
CUTTAGEE LAKE BRIDGE REPLACEMENT
TATHRA - BER MAGUI ROAD, CUTTAGEE, NSW for BEGA VALLEY SHIRE COUNCIL

Copyright © Andrew Marshman & Associates Pty Limited (2009). All rights reserved. This document and all works comprised in it are copyright and no part of it may in any form or by any means including without limitation, electronic, mechanical, microcopying, photocopying, recording, scanning or otherwise be reproduced, modified, sorted in a retrieval system, published, distributed or any part of these works is granted to any person without the express prior written consent of Andrew Marshman & Associates Pty Limited and any implied licence to use any part of these works is expressly excluded.

TITLE		GENERAL ARRANGEMENT PLAN			
Design	Drawn	Approved		ANDREW MARSHMAN	
A. MARSHMAN	D. ELCOAT	BE (HONS) MIE Aust (138976) CPEng NER Chartered Engineer			
Scale	Date	Job. No.	Sheet	Rev.	
1:100 (A1) 1:200 (A3)	AUGUST 2020	AC20022.06	C3.1	P2	

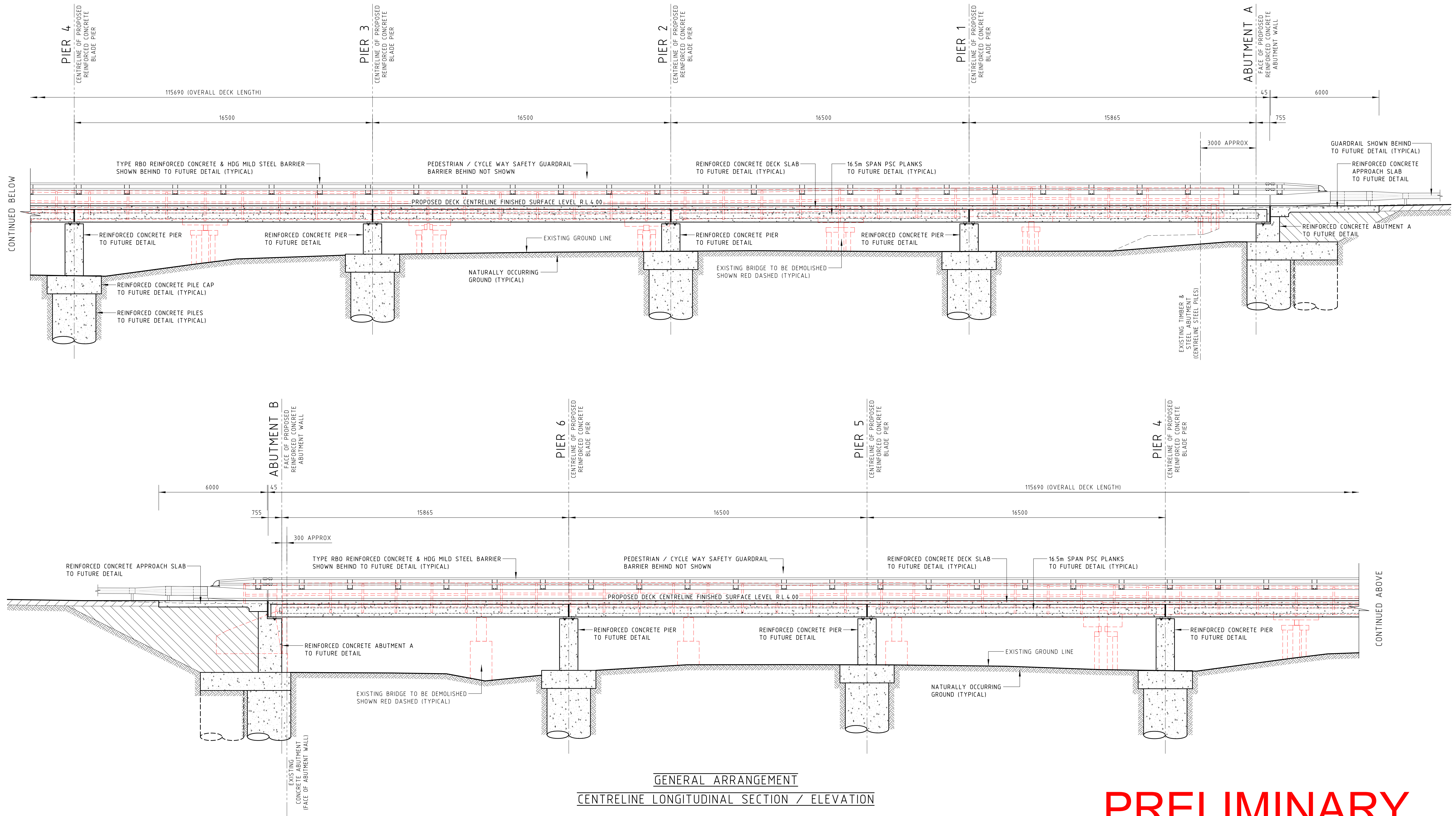

SECTION **1**
C3.1

PRELIMINARY
NOT FOR CONSTRUCTION

Rev.	Description	Eng.	Date	Rev.	Description	Eng.	Date
P1	PRELIMINARY DESIGN ISSUE	A.M.	07.08.20				
P2	PRELIMINARY DESIGN ISSUE	A.M.	12.08.20				

MARSHMAN O'NEILL
ENGINEERS CONSULTING
STRUCTURAL
CIVIL

ANDREW MARSHMAN & ASSOCIATES PTY LTD ABN 86 064 689 696
35a Main Street (P.O. Box 768) Merimbula NSW 258
PH: 02 6495 1670 FAX: 02 6495 3456
andrewmarshmanengineers.com.au

PROJECT
CUTTAGEE LAKE BRIDGE REPLACEMENT
TATHRA - BERMAGUI ROAD, CUTTAGEE, NSW for BEGA VALLEY SHIRE COUNCIL

Copyright © Andrew Marshman & Associates Pty Limited (2009). All rights reserved. This document and all works comprised in it are copyright and no part of it may in any form or by any means including without limitation, electronic, mechanical, microcopying, photocopying, recording, scanning or otherwise be reproduced, modified, sorted in a retrieval system, published, distributed or any part of these works is granted to any person without the express prior written consent of Andrew Marshman & Associates Pty Limited and any implied licence to use any part of these works is expressly excluded.

TITLE		GENERAL ARRANGEMENT CENTRELINE LONGITUDINAL SECTION / ELEVATION			
Design A. MARSHMAN	Drawn D. ELCOAT	Approved ANDREW MARSHMAN <small>BE (HONS) MIE Aust (389076) CPEng NER Chartered Engineer</small>		Job No. AC20022.06	Sheet C3.2
Scale 1:100 (A1) 1:200 (A3)	Date AUGUST 2020	Rev. P2			

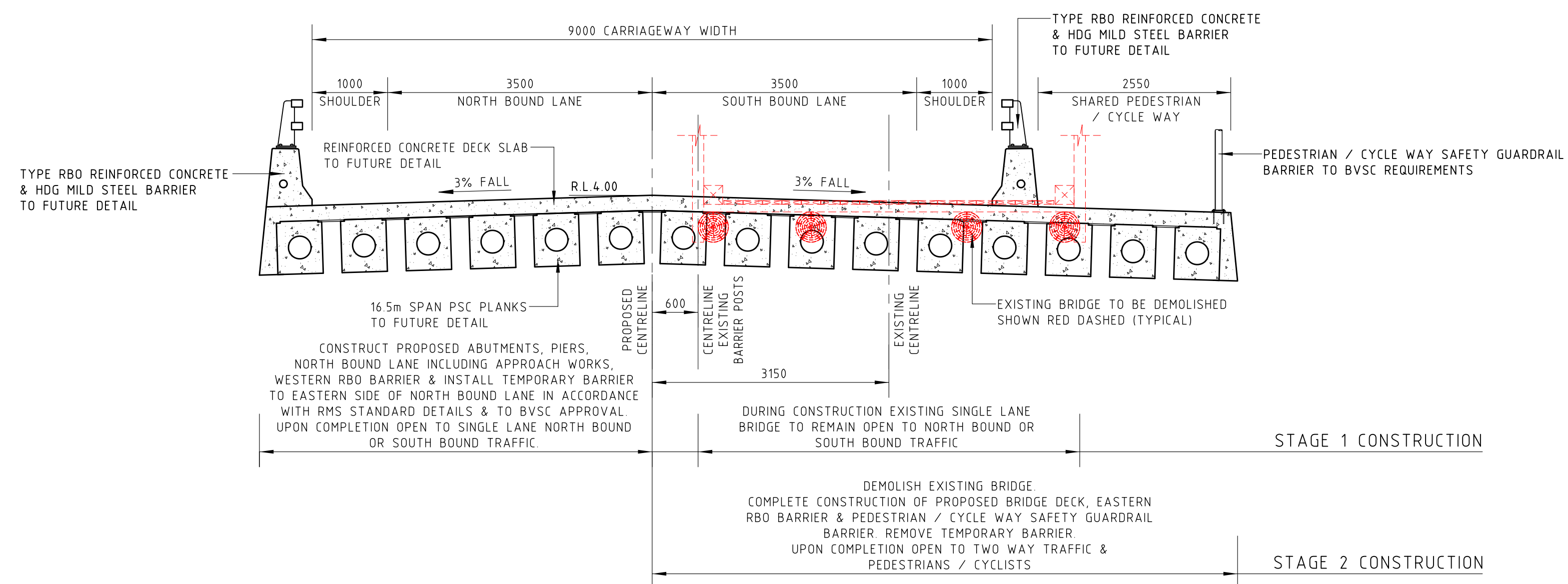

GENERAL ARRANGEMENT
TYPICAL SECTION THROUGH BRIDGE DECK

SECTION 2
C3.1

PRELIMINARY
NOT FOR CONSTRUCTION

Rev.	Description	Eng.	Date	Rev.	Description	Eng.	Date
P1	PRELIMINARY DESIGN ISSUE	A.M.	07.08.20				
P2	PRELIMINARY DESIGN ISSUE	A.M.	12.08.20				
<p>MARSHMAN O'NEILL ENGINEERS CONSULTING STRUCTURAL CIVIL</p> <p>ANDREW MARSHMAN & ASSOCIATES PTY LTD ABN 86 064 689 696 35a Main Street (P.O. Box 768) Merimbula NSW 258 PH: 02 6495 1670 FAX: 02 6495 3456 andrewmarshmanengineers.com.au</p>							
<p>PROJECT: CUTTAGEE LAKE BRIDGE REPLACEMENT TATHRA - BERMAGUI ROAD, CUTTAGEE, NSW for BEGA VALLEY SHIRE COUNCIL</p> <p>Copyright © Andrew Marshman & Associates Pty Limited (2009). All rights reserved. This document and all works comprised in it are copyright and no part of it may in any form or by any means (including without limitation, electronic, mechanical, microcopying, photocopying, recording, scanning or otherwise) be reproduced, modified, sorted in a retrieval system, published, distributed or any part of these works is granted to any person without the express prior written consent of Andrew Marshman & Associates Pty Limited and any implied licence to use any part of these works is expressly excluded.</p>							
TITLE: GENERAL ARRANGEMENT TYPICAL SECTION THROUGH BRIDGE DECK		Design: A. MARSHMAN	Drawn: D. ELCOAT	Approved: ANDREW MARSHMAN BE (HONS) MIE Aust (388076) CPEng NER Chartered Engineer	Job No.: AC20022.06	Sheet: C3.3	Rev.: P2
Scale: 1:50 (A1) 1:100 (A3)		Date: AUGUST 2020					